





emergency stops

Safe and Optically Appealing Emergency-stop Buttons

The user can choose from a wide range of TÜV certified emergency-stop buttons by Schlegel and DUX for panel cut-outs of different shapes and dimensions (16mm, 22mm, 30mm...) which can be combined with both, the standard and ASi contact units. The actuators are well known for their modern and attractive design combining mechanical robustness and outstanding functionality, featuring e.g. a clearly visible switching position indicator, a twist release (in either direction) or pull release and tightness from IP65 to IP69K, depending on the model.

Safety Contact Blocks for Emergency-stop Buttons

Even redundant, secure emergency-stop chains are ineffective unless the contact block is accurately connected with the emergency-stop button. The safety contact blocks by Schlegel Elektrokontakt are the response to this danger that may occur e.g. as a result of a negligent assembly or a mechanical damage. In such a situation they ensure that the emergency function is activated and the installation is switched off immediately. It can only be restarted after successful trouble-shooting. The contact blocks are available with screw connections or Faston terminals and do have positive opening contacts acc.to IEC60947-5-1. They can be supplied with one or two channels and also, when combined with the appropriate E-stop button, in a foolproof version acc. to EN60947-5-5 and EN13850. The high-quality contact elements allow reliable switching even of low currents (5mA at 24V or less). They are available as conventional contact blocks as well as for AS-Interface application (Safety@Work).





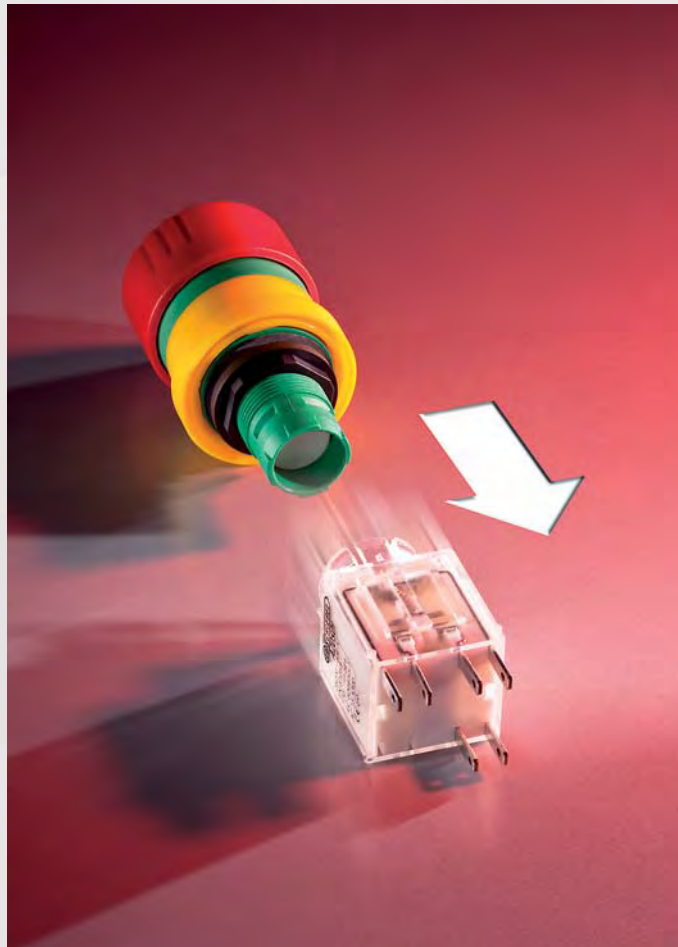





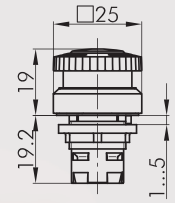

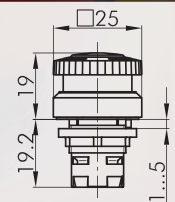
Safety@Work

Safety@Work is an extension of the existing ASi system by safety-related components, such as e.g. emergency stop switches. The great advantage is that standard and safety-related ASi slaves can be used in one and the same system. That means an existing ASi network consisting of ASi master, power supply and slaves, is simply extended by a safety monitor and safe ASi slaves. Safety@Work is based on the standard ASi protocol reaching the safety integrity level 3. As base serves the transmission of dynamic code sequences which are stored in each safe ASi slave.

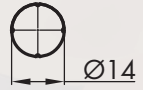

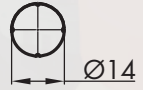
Automatic switch off on separation of the contact block from the emergency-stop button

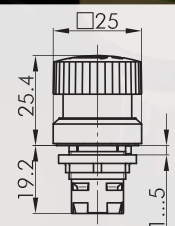
Emergency Stops

Illustration	Dimensions	Description	Type
		<p>Emergency-stop Head Other mushroom colours on request</p> <p>Series OKTRON</p> <p>Panel cut-out Ø 16.2 mm</p> <p>foolproof No</p> <p>switching position indicator No</p> <p>anti-lock collar No</p> <p>release twist right or left</p> <p>suitable contact blocks AZ BZ BZ PTP PTF</p> <p>mushroom head red</p> <p>front bezel yellow</p>	OKVGB
		<p>Emergency-stop Head with illuminating and labelling option including blank nameplate (inscription on request)</p> <p>Series OKTRON</p> <p>Panel cut-out Ø 16.2 mm</p> <p>foolproof No</p> <p>switching position indicator No</p> <p>anti-lock collar No</p> <p>release twist right or left</p> <p>suitable contact blocks AZ BZ BZ</p> <p>mushroom head red</p> <p>front bezel yellow</p>	OKVLBGB
		<p>Nameplate with special imprint as per customer's specification</p>	BSRJB
		<p>Nameplate with standard imprint Please specify index number (see nameplates on pages 404)</p>	BSRJ...
		<p>Blank Nameplate</p>	BSRJU
		<p>Emergency-stop Head</p> <p>Series OKTRON</p> <p>Panel cut-out Ø 16.2 mm</p> <p>foolproof Yes</p> <p>switching position indicator No</p> <p>anti-lock collar No</p> <p>release twist right or left</p> <p>Standard EN 60947-5-1, EN 60947-5-5, EN ISO 13850</p> <p></p> <p>suitable contact blocks AZ BZ BZ PTP PTF</p> <p>mushroom head red</p> <p>front bezel yellow</p>	OKUVGB

Emergency Stops

About Us

Control Units

Actuators

Panel Mount Jocks

Bus Technology

Enclosures

Terminal Blocks

Pedal Switches

Limit Switches

Type Index

Illustration

Dimensions

Description

Type

IP65

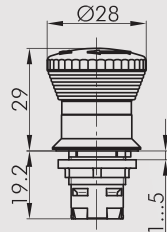

Emergency-stop Head

with snap-action mechanism

Series	OKTRON-R
Panel cut-out	Ø 16.2 mm
foolproof	Yes
switching position indicator	Yes
anti-lock collar	No
release	twist right or left
Standard	EN 60947-5-1, EN 60947-5-5, EN ISO 13850



suitable contact blocks

ASI AZ BZ BZ PTP PTF

mushroom head red
front bezel yellow

RKUV28

IP65

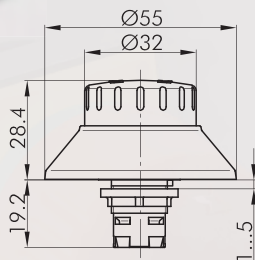

Emergency-stop Head

Series	OKTRON-R
Panel cut-out	Ø 16.2 mm
foolproof	Yes
switching position indicator	Yes
anti-lock collar	Yes
release	twist right or left
Standard	EN 60947-5-1, EN 60947-5-5, EN ISO 13850



suitable contact blocks

ASI AZ BZ BZ

mushroom head red
front bezel yellow

RKUV32

IP65

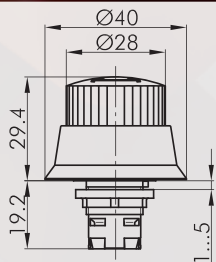

Emergency-stop Head

Series	OKTRON-R
Panel cut-out	Ø 16.2 mm
foolproof	Yes
switching position indicator	No
anti-lock collar	Yes
release	twist right or left
Standard	EN 60947-5-1, EN 60947-5-5, EN ISO 13850



suitable contact blocks

AZ BZ BZ PTP PTF

mushroom head red
front bezel yellow

RKUV40

Emergency Stops Accessories for Actuators

Illustration

Dimensions

Description

Type

IP65

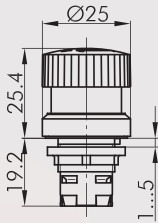

Emergency-stop Head

Series	OKTRON-R
Panel cut-out	Ø 16.2 mm
foolproof	Yes
switching position indicator	No
anti-lock collar	No
release	twist right or left
Standard	EN 60947-5-1, EN 60947-5-5, EN ISO 13850



suitable contact blocks

AZ BZ BZ PTP PTF

mushroom head red
front bezel yellow

RKUVGB

IP65

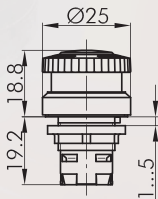

Emergency-stop Head

Other mushroom colours on request

Series	OKTRON-R
Panel cut-out	Ø 16.2 mm
foolproof	No
switching position indicator	No
anti-lock collar	No
release	twist right or left
Standard	EN 60947-5-1, EN 60947-5-5, EN ISO 13850



suitable contact blocks

AZ BZ BZ PTP PTF

mushroom head red
front bezel yellow

RKVGB

IP65

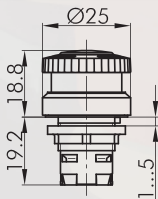

Emergency-stop Head

incl. blank nameplate (inscription on request)

Series	OKTRON-R
Panel cut-out	Ø 16.2 mm
foolproof	No
switching position indicator	No
anti-lock collar	No
release	twist right or left

suitable contact blocks

AZ BZ BZ

mushroom head red
front bezel yellow

RKVLGBB

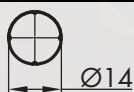

Nameplate with special imprint

as per customer's specification

BSRJB

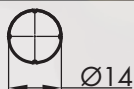

Nameplate with standard imprint

Please specify index number (see nameplates on pages 404)

BSRJ...



Blank Nameplate

BSRJU

Emergency Stops

Illustration

Dimensions

Description

Type

IP65

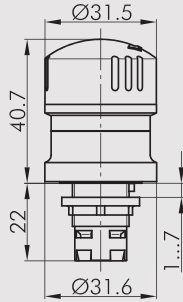

Emergency-stop Head

Series QUARTRON
 Panel cut-out Ø 16.2 mm
 foolproof Yes
 switching position indicator Yes
 anti-lock collar No
 release twist right or left
 Standard EN 60947-5-1, EN 60947-5-5,
 EN ISO 13850



suitable contact blocks

ASI A AZ PTP PTF

mushroom head red
 front bezel yellow

RXUV

IP65

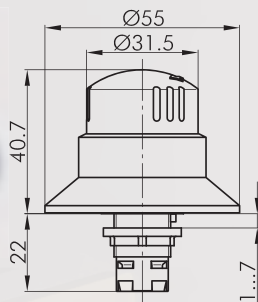

Emergency-stop Head

Series QUARTRON
 Panel cut-out Ø 16.2 mm
 foolproof Yes
 switching position indicator Yes
 anti-lock collar Yes
 release twist right or left
 Standard EN 60947-5-1, EN 60947-5-5,
 EN ISO 13850



suitable contact blocks

ASI A AZ PTP PTF

mushroom head red
 front bezel yellow

RXBUV

IP65

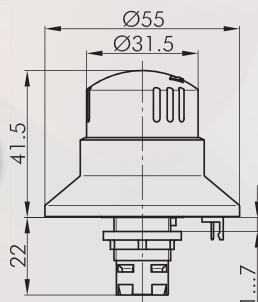

Illuminated Emergency-stop Head

24V / 15mA AC/DC
 Connection of the LED ring illumination possible via
 VK_BKL034 or VK_JST025BKL
 Series QUARTRON
 Panel cut-out Ø 16.2 mm
 foolproof Yes
 switching position indicator Yes
 anti-lock collar Yes
 release twist right or left
 Standard EN 60947-5-1, EN 60947-5-5,
 EN ISO 13850



suitable contact blocks

ASI A AZ PTP PTF

mushroom head red
 front bezel yellow

RXBLUV

About Us

Control Units

Actuators

Panel Mount Jacks

Bus Technology

Enclosures

Terminal Blocks

Pedal Switches

Limit Switches

Type Index

Not-Halt/Not-Aus-Taste

Illustration

Dimensions

Description

Type

IP65

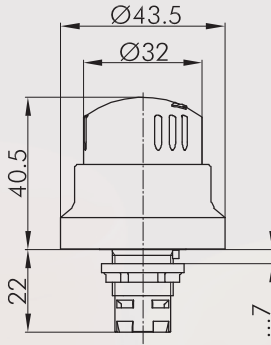

Emergency-stop Head

Series	QUARTRON
Panel cut-out	Ø 16.2 mm
foolproof	Yes
switching position indicator	Yes
anti-lock collar	Yes
release	twist right or left
Standard	EN 60947-5-1, EN 60947-5-5, EN ISO 13850
suitable contact blocks	ASI A AZ PTP PTF
mushroom head	red
front bezel	yellow

RXBUV43



About Us

Control Units

→ Actuators

Panel Mount Jacks

Bus Technology

Enclosures

Terminal Blocks

Pedal Switches

Limit Switches

Type Index

Emergency Stops

Illustration

Dimensions

Description

Type

IP66
IP69K

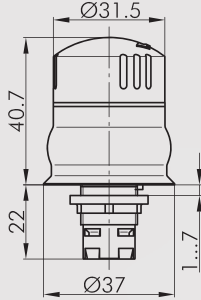

Emergency-stop Head for hygienic applications

Cannot be used with threaded adapter R16x1!
Conforms to BG (= Employer's Liability Insurance Association) in accordance with DIN EN 1672-2 and GS-FW 01/01

Series	QUARTRON
Panel cut-out	Ø 16.2 mm
foolproof	Yes
switching position indicator	No
anti-lock collar	No
release	twist right or left
Standard	EN 60947-5-1, EN 60947-5-5, EN ISO 13850



suitable contact blocks

ASI A AZ PTP PTF

mushroom head	red
front bezel	yellow

RXUVP

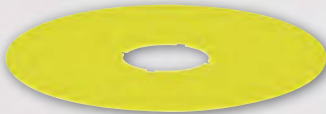

Yellow Nameplate

self-adhesive PVC foil
printing on request
outer dia. 60 mm
for mounting dia. 16 mm
Series QUARTRON
Panel cut-out Ø 16.2 mm
colour yellow

NAS_16



Yellow Nameplate with quadrilingual imprint

self-adhesive PVC foil
outer dia. 60 mm
for mounting dia. 16 mm
Series QUARTRON
Panel cut-out Ø 16.2 mm
colour yellow

NAS_16_548

IP66
IP67
IP69K

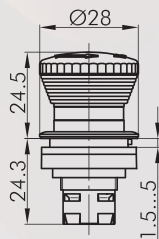

Emergency-stop Head

Series	RONTRON-R-JUWEL
Panel cut-out	Ø 22.3 mm
foolproof	Yes
switching position indicator	Yes
anti-lock collar	No
release	twist right or left
Standard	EN 60947-5-1, EN 60947-5-5, EN ISO 13850



suitable contact blocks

ASI AZ BZ BZ PTP PTF

mushroom head	red
front bezel	yellow

RRJUV

About Us

Control Units
Actuators

Panel Mount Jacks

Bus Technology

Enclosures

Terminal Blocks

Pedal Switches

Limit Switches

Type Index

General Data

Type Reference:	FRVKD(O)(OO)(OI)(P)(_AU)
Description:	Emergency Stop, active/inactive (without diagnostic device)
Approvals:	CE, TÜV_Süd
Nature of contact:	1NC/1NO/1NC+1NO
Degree of protection:	IP65 / IP67
Connection type:	Faston terminals 2.8x0.8 mm / PCB-mount terminals
Contact material:	AgNi / AgNi, gold-plated 5µm
Max. storage temperature:	-40°C ... 80°C
Max. operating temperature:	-25°C ... 70°C
Mechanical life:	50,000
Electrical life (rated load):	50,000 at rated load
Contact resistance NO:	< 50 mOhm (new state)
Contact resistance NC:	< 50 mOhm (new state)
Positive opening contact:	acc. to EN60947-5-1, appendix. K

Electrical data acc. to IEC/EN 60947-5-1 (VDE 0660 Sect. 200)

	alternate current	direct current
Utilisation category:	AC15	DC13
Rated insulation voltage Ui:	250 V	250 V
Rated operating voltage Ue:	35 V	35 V
Rated operating current Ie:	5A	2 A
Breaking capacity:	10Ie	1,1Ie
Continuous thermal current:	5A	2.5A

Technical Data - Lamp

Lamp socket:	none, with integrated 3 mm LED
Definition:	X1...anode, X2...cathode

Additional Data

Mounting aperture:	22.3mm
Tightening torque (mounting nut):	1.3 ... 1.9 Nm
Release:	twist release, left or right
Mounting position:	any
Standards:	ISO 13850:2015(E), EN ISO 13850:2015(D), DIN EN ISO 13850:2016-05
Ld:	20% (NC)
B10d:	250.000
Overtoltage category:	II
Pollution degree :	2
Material group:	I

Note

- with switching position indicator
- a diagnostic unit is not included

Electrical Features - 5µm gold-plating (type addition ...AU)	
Switching voltage	20mV ... 35V AC/DC
Switching current	1mA ... 250mA

For the version with Faston terminals, use partially or fully insulated Faston clamps.

Illuminated version, status indication active/inactive:	acc. to ISO 13850:2015(E), EN ISO 13850:2015(D), DIN EN ISO 13850:2016-05
Mushroom "grey":	"inactive", no emergency stop
Mushroom "red":	"active" emergency stop

Technical Data of LED:

Type:	Opto Devices
Typical data at IF=20mA:	
Luminous intensity:	min. 10000 mcd, typical 13000 mcd
Beam angle:	typical 15°
Dominant wavelength:	618...624 nm, typical 621 nm
Rated voltage:	24 V DC ± 10%
Rated current:	17.8 mA (15,6...19,95mA)
Typical luminous intensity at IF=1.8mA:	min. 9000 mcd, typical 11700 mcd
LED cut-off voltage:	max. 70V
Average life:	approx. 80,000...100,000h

Safety Instructions:

- The emergency stop must only be used when lighting conditions ensure clear and distinct visibility of the red illuminated (active) mushroom.
- Before using the emergency stop, a systematic safety review of the overall system is required.
- Depending on the designer's risk assessment, the illumination of the emergency stop must be monitored by means of a "diagnostic unit", and in case of error one has to react in accordance with the risk evaluation.

Standard compliant applications:

- pluggable stations
- wireless operator stations
- pluggable system components (fixed system components which are only temporarily in operation)

General Data

Type Reference:	FRVK(P)(L)(O)(OO)(OOO)(OI)(OOI)(OII)(Z)(LZ)(P)(_AU)
Description:	Emergency Stop, foolproof
Approvals:	CCC, CE, TÜV_Süd, positive opening contact, UR
Nature of contact:	1NC / 2NC / 3 NC / 1 NC+1NO / 2NC+1NO / 1NC+2NO
Degree of protection:	IP65 / IP67
Connection type:	Faston terminals 2.8x0.8 mm / PCB-mount terminals
Contact material:	AgNi / AgNi, gold-plated 5µm
Max. storage temperature:	-40°C ... 80°C
Max. operating temperature:	-25°C ... 70°C
Mechanical life:	50,000
Electrical life (rated load):	50,000 at rated load
Contact resistance NO:	< 50 mOhm (new state)
Contact resistance NC:	< 50 mOhm (new state)
Bouncing time NO:	< 10 ms
Bouncing time NC:	< 10 ms
Positive opening contact:	acc. to EN60947-5-1, appendix. K

Electrical data acc. to IEC/EN 60947-5-1 (VDE 0660 Sect. 200)

Utilisation category:	alternate current	direct current
Rated insulation voltage Ui:	AC15 B300	DC13 Q300
Rated operating voltage Ue:	250 V	250 V
Rated operating current Ie:	240V / 120V	250V / 125V / 60V / 24V
Breaking capacity:	1.5A / 3A	0.27 A / 0.55 A / 1 A / 2 A
Continuous thermal current:	10Ie	1,1Ie
	5A	

Technical Data - Lamp

Lamp socket:	none, with integrated 3 mm LED
Max. lamp voltage:	30 V AC/DC
Max. lamp output:	4 mA at 24 V DC)
Definition:	X1...anode, X2...cathode

Additional Data

Mounting aperture:	22.3mm
Tightening torque (mounting nut):	1.3 ... 1.9 Nm
Release:	twist release, left or right
Mounting position:	any
Standards:	EN 60947-5-1, EN 60947-5-5, EN ISO 13850
Ld:	20% (NC)
B10d:	250.000
Pollution degree :	3

Note

with switching position indicator

Electrical Features - 5µm gold-plating (type addition ...AU)	
Switching voltage	20mV ... 42V AC/DC
Switching current	1mA ... 250mA

For the version with Faston terminals use partially or fully insulated Faston clamps.
Illuminated version (24V-LED): overvoltage category II (2.5kV), pollution degree 2
Version with 3 contacts: overvoltage category II (2.5 kV), pollution degree 2

FRVKP...	emergency stop for hygienic areas
Approvals:	CE, DGUV-Test
Mechanical life:	20,000 (20°C)
	>6050 (-25°C)
	>6050 (+70°C)
B10d/Ld:	150,000/20% (20°C)
FRVK...(Z)	...emergency stop for base-plate mounting
FRVK...(LZ)	...emergency stop for base-plate mounting with height compensation to use the Shortron series
Approvals:	CE
Snap-fit the corresponding contact block (PTS...) to the actuator neck.	
Spacer sleeves ensure the correct distance between PCB and mounting plate. Screws must be secured against loosening.	

General Data

Type Reference:	FRVKAL(O)(OO)(OOO)(OI)(OOI)(OII)(P)(_AU)
Description:	Emergency Stop, aluminium version, foolproof
Approvals:	CE, TÜV_Süd, positive opening contact, UR
Nature of contact:	1NC / 2NC / 3 NC / 1 NC+1NO / 2NC+1NO / 1NC+2NO
Degree of protection:	IP65 / IP67
Connection type:	Faston terminals 2.8x0.8 mm / PCB-mount terminals
Contact material:	AgNi / AgNi, gold-plated 5µm
Max. storage temperature:	-40°C ... 80°C
Max. operating temperature:	-25°C ... 70°C
Mechanical life:	50,000
Electrical life (rated load):	50,000 at rated load
Contact resistance NO:	< 50 mOhm (new state)
Contact resistance NC:	< 50 mOhm (new state)
Bouncing time NO:	< 10 ms
Bouncing time NC:	< 10 ms
Positive opening contact:	acc. to EN60947-5-1, appendix. K

Electrical data acc. to IEC/EN 60947-5-1 (VDE 0660 Sect. 200)

Utilisation category:	alternate current AC15 B300	direct current DC13 Q300
Rated insulation voltage Ui:	250 V	250 V
Rated operating voltage Ue:	240V / 120V	250V / 125V / 60V / 24V
Rated operating current Ie:	1.5A / 3A	0.27 A / 0.55 A / 1 A / 2 A
Breaking capacity:	10Ie	1,1Ie
Continuous thermal current:	5A	

Additional Data

Mounting aperture:	22.3mm
Tightening torque (mounting nut):	1.3 ... 1.9 Nm
Release:	twist release, left or right
Mounting position:	any
Standards:	EN 60947-5-1, EN 60947-5-5, EN ISO 13850
Pollution degree :	3

Reliability Data

Ld:	20% (NC)
B10d:	250.000

Note

with switching position indicator

Electrical Features - 5µm gold-plating (type addition ...AU)	
Switching voltage	20mV ... 42V AC/DC
Switching current	1mA ... 250mA

For the version with Faston terminals use partially or fully insulated Faston clamps.
Version with 3 contacts: overvoltage category II (2.5 kV), pollution degree 2

Data acc. to UL508

Ratings:	silver: B300, 24Vdc/3A gold: 24Vdc/100mA
----------	--

About Us

Control Units

→ Actuators

Panel Mount Jacks

Bus Technology

Enclosures

Terminal Blocks

Pedal Switches

Limit Switches

Type Index

Emergency Stops

Type addition for gold-plated version _AU (e.g. FRVKOO_AU)

About Us

Control Units

Actuators

Panel Mount Jacks

Bus Technology

Enclosures

Terminal Blocks

Pedal Switches

Limit Switches

Type Index

Illustration

Dimensions

Description

Type

IP66
IP67

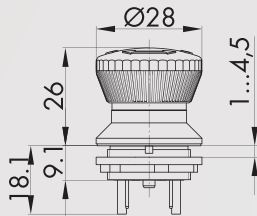

Emergency Stop

Series SHORTRON
 Panel cut-out Ø 22.3 mm
 Connection type Faston terminals 2.8x0.8 mm
 Contact equipment 2NC
 foolproof Yes
 switching position indicator Yes
 anti-lock collar No
 release twist right or left
 Standard EN 60947-5-1, EN 60947-5-5, EN ISO 13850



mushroom head
front bezel

red
yellow

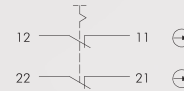

FRVKOO

IP66
IP67

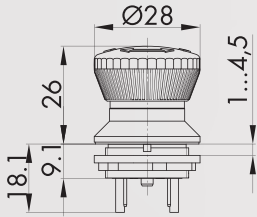

Emergency Stop

Series SHORTRON
 Panel cut-out Ø 22.3 mm
 Connection type Faston terminals 2.8x0.8 mm
 Contact equipment 2NC + 1NO
 foolproof Yes
 switching position indicator Yes
 anti-lock collar No
 release twist right or left
 Standard EN 60947-5-1, EN 60947-5-5, EN ISO 13850



mushroom head
front bezel

red
yellow

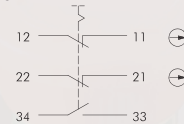

FRVKOOI

IP66
IP67

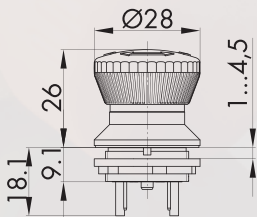

Illuminated Emergency Stop

Series SHORTRON
 Panel cut-out Ø 22.3 mm
 Connection type Faston terminals 2.8x0.8 mm
 Contact equipment 2NC
 foolproof Yes
 switching position indicator Yes
 anti-lock collar No
 release twist right or left
 Standard EN 60947-5-1, EN 60947-5-5, EN ISO 13850



mushroom head
front bezel

red
yellow

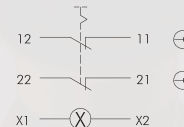

FRVKLOO

Emergency Stops

Type addition for gold-plated version _AU (e.g. _FRVKALOO_AU)

About Us

Control Units

→ Actuators

Panel Mount Jacks

Bus Technology

Enclosures

Terminal Blocks

Pedal Switches

Limit Switches

Type Index

Illustration

Dimensions

Description

Type

IP66
IP67

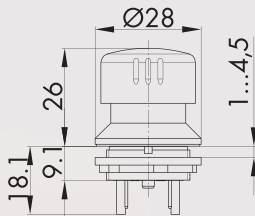

Emergency Stop, made of aluminium for robust applications

Series SHORTRON
 Panel cut-out Ø 22.3 mm
 Connection type Faston terminals 2.8x0.8 mm
 Contact equipment 2NC
 foolproof Yes
 switching position indicator Yes
 anti-lock collar No
 release twist right or left
 Standard EN 60947-5-1, EN 60947-5-5, EN ISO 13850



mushroom head
front bezel

red
yellow

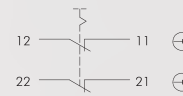

FRVKALOO

IP66
IP67

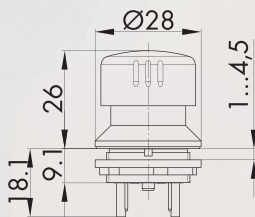

Emergency Stop made of aluminium for robust applications

Series SHORTRON
 Panel cut-out Ø 22.3 mm
 Connection type Faston terminals 2.8x0.8 mm
 Contact equipment 2NC + 1NO
 foolproof Yes
 switching position indicator Yes
 anti-lock collar No
 release twist right or left
 Standard EN 60947-5-1, EN 60947-5-5, EN ISO 13850



mushroom head
front bezel

red
yellow

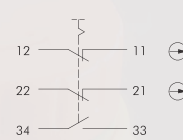

FRVKALOOI

IP66

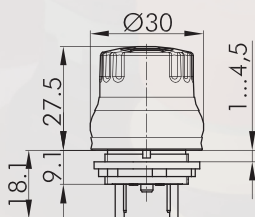

Emergency Stop for hygienic applications

Hygiene-tested acc. to DIN EN 1672-2 / DIN EN ISO 14159 and GS-NV 3, GS-NV 6

Series SHORTRON
 Panel cut-out Ø 22.3 mm
 Connection type Faston terminals 2.8x0.8 mm
 Contact equipment 2NC
 foolproof Yes
 switching position indicator No
 anti-lock collar No
 release twist right or left
 Standard EN 60947-5-1, EN 60947-5-5, EN ISO 13850



mushroom head
front bezel

red
yellow

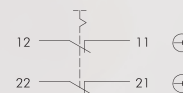

FRVKPOO

Emergency Stops

Type addition for gold-plated version _AU (e.g. FRVKOO_AU)

Illustration

Dimensions

Description

Type

IP66

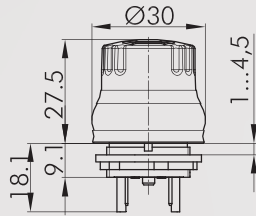

Emergency Stop for hygienic applications

Hygienic test acc. to DIN EN 1672-2 / DIN EN ISO 14159 and GS-NV 3, GS-NV 6

Series	SHORTRON
Panel cut-out	Ø 22.3 mm
Connection type	Faston terminals 2.8x0.8 mm
Contact equipment	2NC + 1NO
foolproof	Yes
switching position indicator	No
anti-lock collar	No
release	twist right or left
Standard	EN 60947-5-1, EN 60947-5-5, EN ISO 13850



mushroom head
front bezel

red
yellow

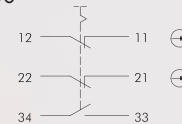

FRVKPOOI

IP66
IP67

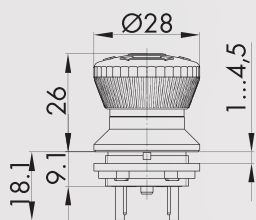

Emergency Stop with pull and twist release

Series	SHORTRON
Panel cut-out	Ø 22.3 mm
Connection type	Faston terminals 2.8x0.8 mm
Contact equipment	2NC
foolproof	Yes
switching position indicator	Yes
anti-lock collar	No
release	pull/twist
Standard	EN 60947-5-1, EN 60947-5-5, EN ISO 13850

mushroom head
front bezel

red
yellow



FRZVKOO

IP66
IP67

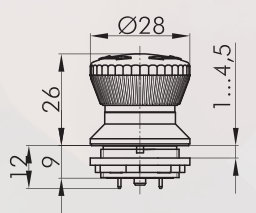

Emergency Stop

Series	SHORTRON
Panel cut-out	Ø 22.3 mm
Connection type	PCB-mount terminals
Contact equipment	2NC
foolproof	Yes
switching position indicator	Yes
anti-lock collar	No
release	twist right or left
Standard	EN 60947-5-1, EN 60947-5-5, EN ISO 13850



mushroom head
front bezel

red
yellow



FRVKOOP

Emergency Stops

Type addition for gold-plated version _AU (e.g. _FRVKALOO_AU)

Illustration	Dimensions	Description	Type
 <p>IP66 IP67</p>		<p>Emergency Stop</p> <p>Series SHORTRON Panel cut-out Ø 22.3 mm Connection type PCB-mount terminals Contact equipment 2NC + 1NO foolproof Yes switching position indicator Yes anti-lock collar No release twist right or left Standard EN 60947-5-1, EN 60947-5-5, EN ISO 13850</p> <p></p> <p>mushroom head red front bezel yellow</p> <p></p>	FRVKOOIP
 <p>IP66 IP67</p> <p></p>		<p>Illuminated Emergency Stop</p> <p>Series SHORTRON Panel cut-out Ø 22.3 mm Connection type PCB-mount terminals Contact equipment 2NC foolproof Yes switching position indicator Yes anti-lock collar No release twist right or left Standard EN 60947-5-1, EN 60947-5-5, EN ISO 13850</p> <p></p> <p>mushroom head red front bezel yellow</p> <p></p>	FRVKLOOP
		<p>Yellow Nameplate</p> <p>self-adhesive PVC foil printing on request outer dia. 75 mm for mounting dia. 22 mm</p> <p>Series SHORTRON Panel cut-out Ø 22.3 mm colour yellow</p>	NAS_22
		<p>Yellow Nameplate with quadrilingual imprint</p> <p>self-adhesive PVC foil outer dia. 75 mm for mounting dia. 22 mm</p> <p>Series SHORTRON Panel cut-out Ø 22.3 mm colour yellow</p>	NAS_22_548

About Us

Control Units

Panel Mount Jacks

Bus Technology

Enclosures

Terminal Blocks

Pedal Switches

Limit Switches

Type Index

→ Actuators

Emergency Stops

About Us

Control Units

Actuators

Panel Mount Jacks

Bus Technology

Enclosures

Terminal Blocks

Pedal Switches

Limit Switches

Type Index

Illustration

Dimensions

Description

Type

IP65

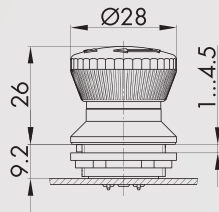

Emergency Stop for 9.2 mm mounting depth

Series	Shortron for base-plate mounting
Panel cut-out	Ø 22.3 mm
foolproof	Yes
switching position indicator	Yes
anti-lock collar	No
release	twist right or left
Standard	EN 60947-5-1, EN 60947-5-5, EN ISO 13850



suitable contact blocks

P

mushroom head red
front bezel yellow

FRVK

IP65

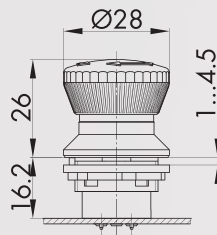

Emergency Stop for 16.2 mm mounting depth

ATTENTION: only suitable for illuminated contact units!

Series	Shortron for base-plate mounting
Panel cut-out	Ø 22.3 mm
foolproof	Yes
switching position indicator	Yes
anti-lock collar	No
release	twist right or left
Standard	EN 60947-5-1, EN 60947-5-5, EN ISO 13850

suitable contact blocks

P

mushroom head red
front bezel yellow

FRVKZ

IP65

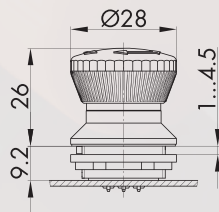

Illuminated Emergency Stop for 9.2mm mounting depth

Series	Shortron for base-plate mounting
Panel cut-out	Ø 22.3 mm
foolproof	Yes
switching position indicator	Yes
anti-lock collar	No
Standard	EN 60947-5-1, EN 60947-5-5, EN ISO 13850



suitable contact blocks

P

mushroom head red
front bezel yellow

FRVKL

Emergency Stops

Illustration

Dimensions

Description

Type

IP65

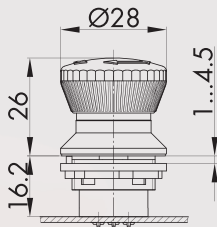

Illuminated Emergency Stop for 16.2 mm mounting depth

ATTENTION: only suitable for illuminated contact units!

Series	Shortron for base-plate mounting
Panel cut-out	Ø 22.3 mm
foolproof	Yes
switching position indicator	Yes
anti-lock collar	No
Standard	EN 60947-5-1, EN 60947-5-5, EN ISO 13850

suitable contact blocks



mushroom head red
front bezel yellow

FRVKZL

IP65

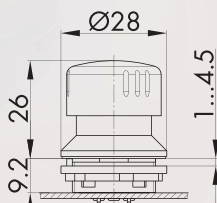

Emergency Stop made of aluminium for robust applications for 9.2 mm mounting depth

Series	Shortron for base-plate mounting
Panel cut-out	Ø 22.3 mm
foolproof	Yes
switching position indicator	Yes
anti-lock collar	No
release	twist right or left
Standard	EN 60947-5-1, EN 60947-5-5, EN ISO 13850



suitable contact blocks



mushroom head red
front bezel yellow

FRVKAL

IP65

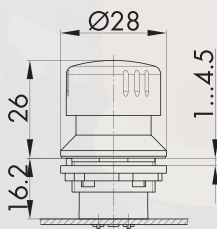

Emergency Stop, aluminium for robust applications for 16.2 mm mounting depth

Series	Shortron for base-plate mounting
Panel cut-out	Ø 22.3 mm
foolproof	Yes
switching position indicator	Yes
anti-lock collar	No
release	twist right or left
Standard	EN 60947-5-1, EN 60947-5-5, EN ISO 13850

suitable contact blocks



mushroom head red
front bezel yellow

FRVKZAL

About Us

Control Units

→ Actuators

Panel Mount Jacks

Bus Technology

Enclosures

Terminal Blocks

Pedal Switches

Limit Switches

Type Index

Emergency Stops

Illustration

Dimensions

Description

Type

IP66

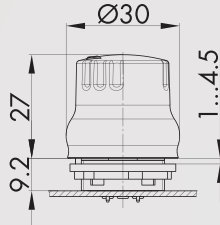

Emergency Stop for hygienic applications for 9.2 mm mounting depth

Hygienic test acc. to DIN EN 1672-2 / DIN EN ISO 14159 and GS-NV 3, GS-NV 6

Series	Shortron for base-plate mounting
Panel cut-out	Ø 22.3 mm
foolproof	Yes
switching position indicator	No
anti-lock collar	No
release	twist right or left
Standard	EN 60947-5-1, EN 60947-5-5, EN ISO 13850

suitable contact blocks

P

mushroom head	red
front bezel	yellow

FRVKP

IP66

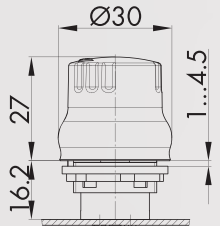

Emergency Stop for hygienic applications for 16.2 mm mounting depth

Hygienic test acc. to DIN EN 1672-2 / DIN EN ISO 14159 and GS-NV 3, GS-NV 6

Series	Shortron for base-plate mounting
Panel cut-out	Ø 22.3 mm
foolproof	Yes
switching position indicator	No
anti-lock collar	No
release	twist right or left
Standard	EN 60947-5-1, EN 60947-5-5, EN ISO 13850

suitable contact blocks

P

mushroom head	red
front bezel	yellow

FRVKZP



Yellow Nameplate

self-adhesive PVC foil
printing on request
outer dia. 75 mm
for mounting dia. 22 mm

Series	SHORTRON
Panel cut-out	Ø 22.3 mm
colour	yellow

NAS_22

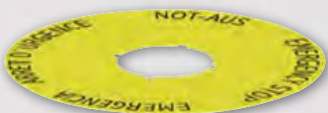

Yellow Nameplate with quadrilingual imprint

self-adhesive PVC foil
outer dia. 75 mm
for mounting dia. 22 mm

Series	SHORTRON
Panel cut-out	Ø 22.3 mm
colour	yellow

NAS_22_548

About Us

Control Units

Actuators

Panel Mount Jacks

Bus Technology

Enclosures

Terminal Blocks

Pedal Switches

Limit Switches

Type Index

Emergency Stops

Illustration

Dimensions

Description

Type

IP66
IP67

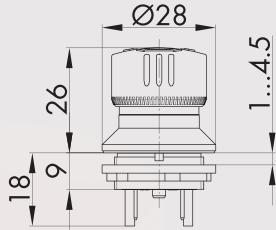

Active Illuminated Safety Emergency Stop with position indication active/inactive

Delivery without diagnostic unit for LED monitoring
LED: 24V DC/18mA

Series	SHORTRON
Panel cut-out	Ø 22.3 mm
Connection type	Faston terminals 2.8x0.8 mm
Contact equipment	2NC
foolproof	Yes
switching position indicator	Yes
anti-lock collar	No
release	twist right or left
Standard	ISO 13850:2015(E), EN ISO 13850:2015(D), DIN EN ISO 13850:2016-05

mushroom head
front bezel

red
yellow

FRVKDOO

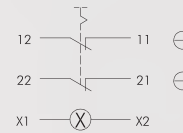

About Us

Control Units

→ Actuators

Panel Mount Jacks

Bus Technology

Enclosures

Terminal Blocks

Pedal Switches

Limit Switches

Type Index

General Data

Type Reference:	YV(O)(OO)(OOI)(LOO)(LO)(_AU)
Description:	Emergency Stop, foolproof
Approvals:	CE, TÜV_Süd
Nature of contact:	2NC / 2NC+1NO / 1NC
Degree of protection:	IP65 / IP67
Connection type:	Faston terminals 2.8 mm x 0.5 mm
Contact material:	AgNi / AgNi, gold-plated 5µm
Max. storage temperature:	-40°C ... 80°C
Max. operating temperature:	-25°C ... 70°C
Mechanical life:	30,000
Electrical life (rated load):	30,000 at rated load
Contact resistance NO:	< 20 mOhm/< 50 mOhm (Au)
Contact resistance NC:	< 20 mOhm/< 50 mOhm (Au)
Bouncing time NO:	< 10 ms
Bouncing time NC:	< 10ms
Positive opening contact:	acc. to EN60947-5-1,appendix. K

Electrical data acc. to IEC/EN 60947-5-1 (VDE 0660 Sect. 200)

Utilisation category:	alternate current	direct current
Rated insulation voltage Ui:	AC15	DC13
Rated operating voltage Ue:	250 V	250V
Rated operating current Ie:	35 V	35 V
Breaking capacity:	5A	2 A
Continuous thermal current:	10Ie	1,1Ie
	5A	

Technical Data - Lamp

Lamp socket:	none, with integrated LED
Max. lamp voltage:	30 V AC/DC
Max. lamp output:	8mA/4.5mA (bei 24 V DC/AC)
Definition:	X1...anode, X2...cathode

Additional Data

Mounting aperture:	16.2 mm
Tightening torque (mounting nut):	0.8 ... 1.5 Nm
Release:	twist release, left or right
Mounting position:	any
Standards:	EN 60947-5-1, EN 60947-5-5, EN ISO 13850
Material group:	I
Overvoltage category:	II
Pollution degree :	2

Electrical Features

Operational voltage:	20 mV...35 V AC/DC
Operational current AC/DC:	max. 100 mA
:	max. 100 mA
Ld:	20% (NC)
B10d:	250.000

Note

- with switching position indicator

- Use partially insulated Faston clamps
Recommend Schlegel type "FHTI2,8x0,5_01"

0.5-1.5mm² (AWG 20-16)
-30°C - 75°C

Supplementary data for versions without 3rd contact assignment/illumination (type YVOO):

acc. to IEC/EN 60947-5-1 (VDE 0660 sect. 200)

AC15 B300:	240V 1.5A
DC13 Q300:	250V 0.27A

Emergency Stops

Illustration

Dimensions

Description

Type

IP65
IP67

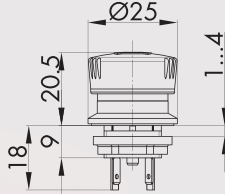

Emergency Stop

Series mYnitron
 Panel cut-out Ø 16.2 mm
 Connection type Faston terminals 2.8 mm x 0.5 mm
 Contact equipment 1NC
 foolproof Yes
 switching position indicator Yes
 anti-lock collar No
 release twist right or left
 Standard EN 60947-5-1, EN 60947-5-5, EN ISO 13850

mushroom head
front bezel

red
yellow



YVO

IP65
IP67

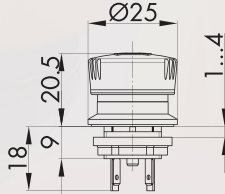

Emergency Stop

Series mYnitron
 Panel cut-out Ø 16.2 mm
 Connection type Faston terminals 2.8 mm x 0.5 mm
 Contact equipment 2NC
 foolproof Yes
 switching position indicator Yes
 anti-lock collar No
 release twist right or left
 Standard EN 60947-5-1, EN 60947-5-5, EN ISO 13850

mushroom head
front bezel

red
yellow

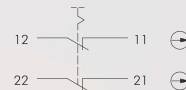

YVOO

IP65
IP67

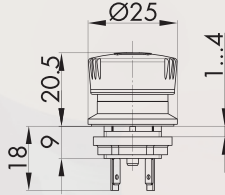

Emergency Stop

Series mYnitron
 Panel cut-out Ø 16.2 mm
 Connection type Faston terminals 2.8 mm x 0.5 mm
 Contact equipment 2NC + 1NO
 foolproof Yes
 switching position indicator Yes
 anti-lock collar No
 release twist right or left
 Standard EN 60947-5-1, EN 60947-5-5, EN ISO 13850

mushroom head
front bezel

red
yellow

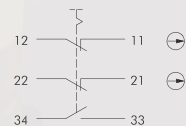

YVOOI

IP65
IP67

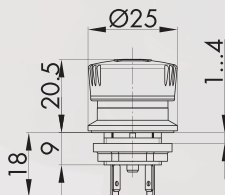

Illuminated Emergency Stop

Series mYnitron
 Panel cut-out Ø 16.2 mm
 Connection type Faston terminals 2.8 mm x 0.5 mm
 Contact equipment 1NC
 foolproof Yes
 switching position indicator Yes
 anti-lock collar No
 release twist right or left
 Standard EN 60947-5-1, EN 60947-5-5, EN ISO 13850

mushroom head
front bezel

red
yellow

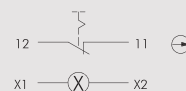

YVLO

Emergency Stops

Type addition for gold-plated version _AU (e. g. YVLOO_AU)

About Us

Control Units

Actuators

Panel Mount Jacks

Bus Technology

Enclosures

Terminal Blocks

Pedal Switches

Limit Switches

Type Index

Illustration

Dimensions

Description

Type

IP65
IP67

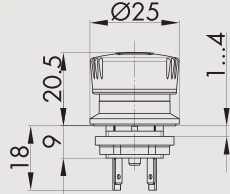

Illuminated Emergency Stop

Series: mYnitron
 Panel cut-out: Ø 16.2 mm
 Connection type: Faston terminals 2.8 mm x 0.5 mm
 Contact equipment: 2NC
 foolproof: Yes
 switching position indicator: Yes
 anti-lock collar release: No
 Standard: twist right or left
 EN 60947-5-1, EN 60947-5-5, EN ISO 13850

mushroom head
front bezel

red
yellow

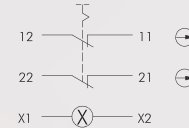

YVLOO



Faston Clamp 2.8 x 0.5, partially insulated, with snap-in pin, for connection to YV... types

Cross section: 0.5-1.5mm²
 AWG: 20-16
 Material: brass, partially insulated, with snap-in pin
 Max. current: 10A
 Max. voltage: 300V
 Temperature: -30°C - 70°C
 UL Listed E70188



Emergency Stops Mushroom Heads

Illustration

Dimensions

Description

Type

IP65

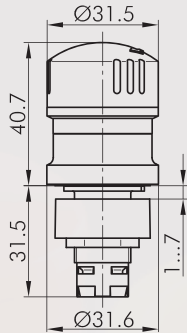

Emergency-stop Head

Series	RX-JUWEL
Panel cut-out	Ø 22.3 mm
foolproof	Yes
switching position indicator	Yes
anti-lock collar	No
release	twist right or left
Standard	EN 60947-5-1, EN 60947-5-5, EN ISO 13850



suitable contact blocks

ASI A AZ PTP PTF

mushroom head red
front bezel yellow

RXJUW

IP65

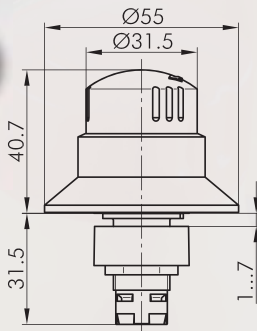

Emergency-stop Head

Series	RX-JUWEL
Panel cut-out	Ø 22.3 mm
foolproof	Yes
switching position indicator	Yes
anti-lock collar	Yes
release	twist right or left
Standard	EN 60947-5-1, EN 60947-5-5, EN ISO 13850



suitable contact blocks

ASI A AZ PTP PTF

mushroom head red
front bezel yellow

RXJBUV

IP65

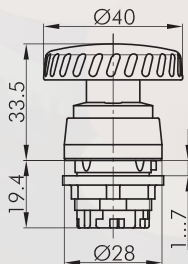

Mushroom Head, latch-type

other mushroom colours on request must be mounted onto yellow background!	
Series	RONDEX
Panel cut-out	Ø 22.3 mm
foolproof	No
switching position indicator	No
anti-lock collar	No
release	twist
Standard	EN 60947-5-1, EN 60947-5-5, EN ISO 13850



suitable contact blocks

DS DT ET M

mushroom head red
front bezel charcoal

RV

About Us

Control Units

→ Actuators

Panel Mount Jacks

Bus Technology

Enclosures

Terminal Blocks

Pedal Switches

Limit Switches

Type Index

Mushroom Heads Emergency Stops

About Us

Control Units

Actuators

Panel Mount Jacks

Bus Technology

Enclosures

Terminal Blocks

Pedal Switches

Limit Switches

Type Index

Illustration

Dimensions

Description

Type

IP65

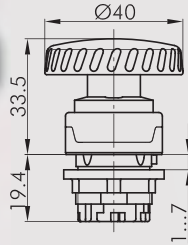

Mushroom Head, latch-type

other mushroom colours on request
must be mounted onto yellow background!

Series	RONDEX-M
Panel cut-out	Ø 22.3 mm
foolproof	No
switching position indicator	No
anti-lock collar	No
release	twist
Standard	EN 60947-5-1, EN 60947-5-5, EN ISO 13850

suitable contact blocks



mushroom head	red
front bezel	metallic/charcoal

RMCV

IP65

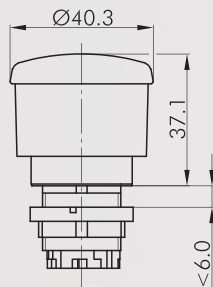

Emergency-stop Head with inscription

other mushroom colours on request, must be mounted onto yellow background!

Series	DUX-Basic
Panel cut-out	Ø 22.3 mm
switching position indicator	Yes
anti-lock collar	No
release	pull
Standard	EN 60947-5-1, EN 60947-5-5, EN ISO 13850, EN 81-2 Abschnitt 15



suitable contact blocks



mushroom head	red
front bezel	black green

**DXRVS40SS
DXRVG40SS**

IP65

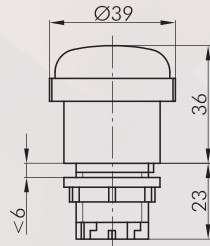

Emergency-stop Head with arrow

must be mounted onto yellow background!

Series	DUX-Basic
switching position indicator	Yes
anti-lock collar	No
release	twist
Standard	EN 60947-5-1, EN 60947-5-5, EN ISO 13850, EN 81-2 Abschnitt 15



suitable contact blocks



mushroom head	red
front bezel	grey

DXRV39PF

Emergency Stops

Illustration

Dimensions

Description

Type

IP65

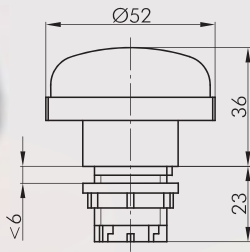

Emergency-stop Head

Series DUX-Basic
other mushroom colours on request, must be mounted onto yellow background!

Panel cut-out Ø 22.3 mm
switching position indicator No
anti-lock collar No
release twist
Standard EN 60947-5-1, EN 60947-5-5, EN ISO 13850



suitable contact blocks

DS DT ET M

mushroom head	red	DXRV52MRT
front bezel	polished	
	grey	
	black	DXRV52GRT
		DXRV52SRT

IP65
IP69K

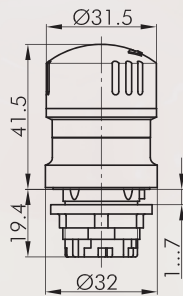

Emergency-stop Head

Series QUARTEX-R
Panel cut-out Ø 22.3 mm
foolproof Yes
switching position indicator Yes
anti-lock collar No
release twist right or left
Standard EN 60947-5-1, EN 60947-5-5, EN ISO 13850



suitable contact blocks

ASI DS DT ET M

mushroom head	red	QRUV
front bezel	yellow	

About Us

Control Units

→ Actuators

Panel Mount Jacks

Bus Technology

Enclosures

Terminal Blocks

Pedal Switches

Limit Switches

Type Index

Emergency Stops

Illustration

Dimensions

Description

Type

IP66
IP69K

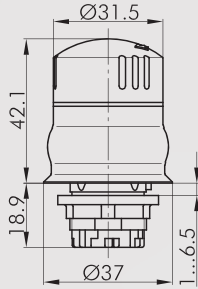

Emergency-stop Head for hygienic applications

conforms to BG (= Employer's Liability Insurance Association) in accordance with DIN EN 1672-2 and GS-FW 01/01

Series QUARTEX-R

Panel cut-out Ø 22.3 mm

foolproof Yes

switching position indicator No

anti-lock collar No

release twist right or left

Standard EN 60947-5-1, EN 60947-5-5, EN ISO 13850



suitable contact blocks



mushroom head

red

front bezel

yellow

QRUVP

IP65
IP69K

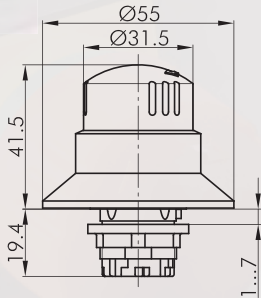

Emergency-stop Head

Series QUARTEX-R

Panel cut-out Ø 22.3 mm

foolproof Yes

switching position indicator Yes

anti-lock collar Yes

release twist right or left

Standard EN 60947-5-1, EN 60947-5-5, EN ISO 13850



suitable contact blocks



mushroom head

red

front bezel

yellow

QRBUV

IP65
IP69K

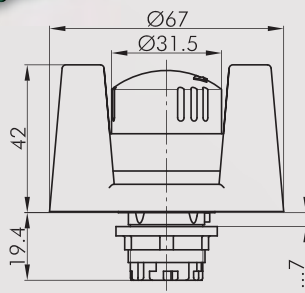

Emergency-stop Head with protective shroud

NOTE: The user must ensure the emergency stop with protective shroud to be easy accessible!

Series QUARTEX-R

Panel cut-out Ø 22.3 mm

foolproof Yes

switching position indicator Yes

anti-lock collar Yes

release twist right or left

Standard EN 60947-5-1, EN 60947-5-5, EN ISO 13850



suitable contact blocks



mushroom head

red

front bezel

yellow

QRSKUV

Emergency Stops

About Us

Control Units

→ Actuators

Panel Mount Jacks

Bus Technology

Enclosures

Terminal Blocks

Pedal Switches

Limit Switches

Type Index

Illustration

Dimensions

Description

Type

IP65
IP69K

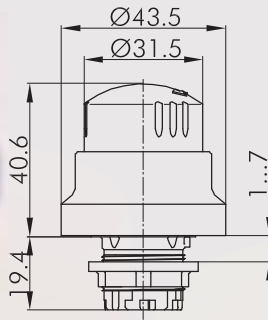

Emergency-stop Head

Series QUARTEX-R
 Panel cut-out Ø 22.3 mm
 foolproof Yes
 switching position indicator Yes
 anti-lock collar Yes
 release twist right or left
 Standard EN 60947-5-1, EN 60947-5-5,
 EN ISO 13850

suitable contact blocks

ASI DS DT ET M

mushroom head red
 front bezel yellow

QRBUV43

IP66

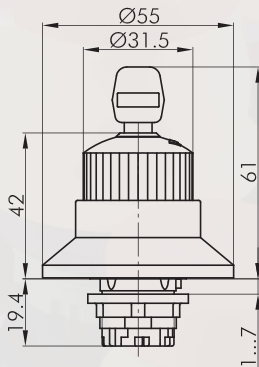

Emergency-stop Head

Series QUARTEX-R
 Panel cut-out Ø 22.3 mm
 foolproof Yes
 switching position indicator Yes
 anti-lock collar Yes
 release key release
 Standard EN 60947-5-1, EN 60947-5-5,
 EN ISO 13850



suitable contact blocks

ASI DS DT ET M

mushroom head red
 front bezel yellow

QRBUVSE

IP66

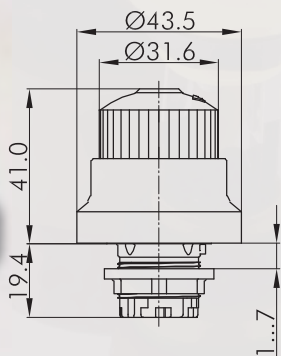

Emergency-stop Head

Series QUARTEX-R
 Panel cut-out Ø 22.3 mm
 foolproof Yes
 switching position indicator Yes
 anti-lock collar Yes
 release key release
 Standard EN 60947-5-1, EN 60947-5-5,
 EN ISO 13850

suitable contact blocks

ASI DS DT ET M

mushroom head red
 front bezel yellow

QRBUVSE43

Emergency Stops

Illustration

Dimensions

Description

Type

IP66



Emergency-stop Head with protective shroud

NOTE: The user must ensure the emergency stop with protective shroud to be easy accessible!

Series	QUARTEX-R
Panel cut-out	Ø 22.3 mm
foolproof	Yes
switching position indicator	Yes
anti-lock collar	Yes
release	key release
Standard	EN 60947-5-1, EN 60947-5-5, EN ISO 13850



suitable contact blocks

ASI DS DT ET M

mushroom head	red
front bezel	yellow

QRSKUVE

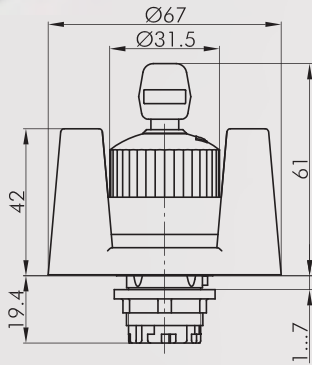

IP65



Emergency-stop Head

In its active state, the emergency-stop head can be latched with a U-lock.

The U-lock is not included with the delivery scope.

Note: The user must ensure easy accessibility of the E-stop with protective collar!

Series	QUARTEX-R
Panel cut-out	Ø 22.3 mm
foolproof	Yes
switching position indicator	Yes
anti-lock collar	Yes
release	twist right or left

suitable contact blocks

ASI DS DT ET M

mushroom head	red
front bezel	yellow

QRSKUV_556

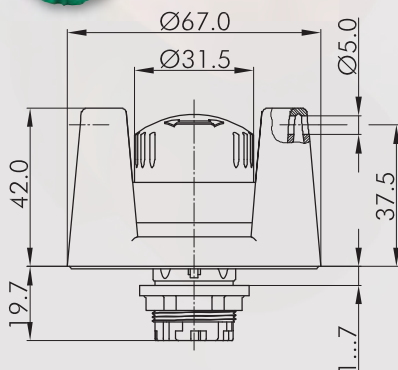

Emergency Stops

About Us

Control Units

→ Actuators

Panel Mount Jacks

Bus Technology

Enclosures

Terminal Blocks

Pedal Switches

Limit Switches

Type Index

Illustration

Dimensions

Description

Type

IP65

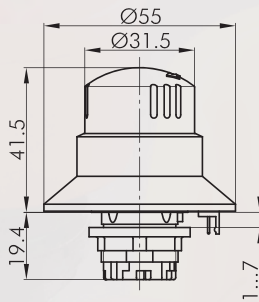

Illuminated Emergency-stop Head

with illuminated anti-lock collar, 24V / 15mA AC/DC, connection of LED ring illumination possible via VK_BKL034, VK_JST025BKL or MAL

Series	QUARTEX-R
Panel cut-out	Ø 22.3 mm
foolproof	Yes
switching position indicator	Yes
anti-lock collar	Yes
release	twist right or left
Standard	EN 60947-5-1, EN 60947-5-5, EN ISO 13850



suitable contact blocks

ASI DS DT ET M

mushroom head red
front bezel yellow

QRBLUV

IP65

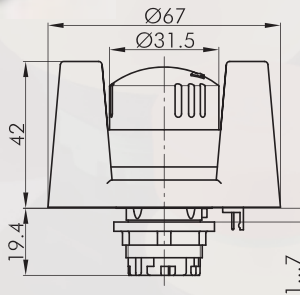

Emergency-stop Head with illuminated protective shroud

24V / 15mA AC/DC, connection of LED ring illumination possible via VK_BKL034, VK_JST025BKL or MAL

NOTE: The user must ensure the emergency stop with protective shroud to be easy accessible!

Series	QUARTEX-R
Panel cut-out	Ø 22.3 mm
foolproof	Yes
switching position indicator	Yes
anti-lock collar	Yes
release	twist right or left
Standard	EN 60947-5-1, EN 60947-5-5, EN ISO 13850



suitable contact blocks

DS DT ET M

mushroom head red
front bezel yellow

QRSKLUV

Emergency Stops

Illustration

Dimensions

Description

Type

IP65

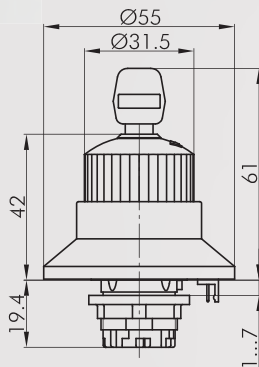

Illuminated Emergency-stop Head

with illuminated anti-lock collar, 24V / 15mA AC/DC, connection of LED ring illumination possible via VK_BKL043, VK_JST025BKL or MAL

Series	QUARTEX-R
Panel cut-out	Ø 22.3 mm
foolproof	Yes
switching position indicator	Yes
anti-lock collar	Yes
release	key release
Standard	EN 60947-5-1, EN 60947-5-5, EN ISO 13850



suitable contact blocks



mushroom head	red
front bezel	yellow

QRBLUVSE

IP65

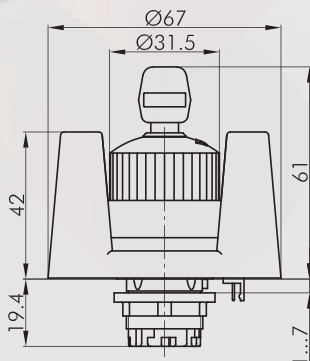

Emergency-stop Head with illuminated protective shroud

24V / 15mA AC/DC, connection of LED ring illumination possible via VK_BKL034, VK_JST025BKL or MAL

NOTE: The user must ensure the emergency stop with protective shroud to be easy accessible!

Series	QUARTEX-R
Panel cut-out	Ø 22.3 mm
foolproof	Yes
switching position indicator	Yes
anti-lock collar	Yes
release	key release
Standard	EN 60947-5-1, EN 60947-5-5, EN ISO 13850



suitable contact blocks



mushroom head	red
front bezel	yellow

QRSKLUVSE

About Us

Control Units

Panel Mount Jocks

Bus Technology

Enclosures





Terminal Blocks

Pedal Switches

Limit Switches

Type Index

Accessories for Actuators

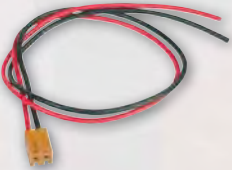
Illustration	Dimensions	Description	Type
		<p>Connection Module</p> <p>serves to connect the illuminated emergency stops via a screw terminal. The connection module is snapped into the module holders MHR_3 or MHR_5 12-30V, AC/DC, max. 44mA Series QUARTEX-R Connection type screw connection 2x2.5mm²</p> <p> </p> <p>colour white</p>	MAL
		<p>Connection Cable</p> <p>serves to connect an illuminated emergency-stop pushbutton to a AS-Interface slave (Safety at Work), 2-core strand, red/black, 0.25 mm², with male connector crimped on both sides, length: approx. 10 cm</p>	VK_JST025BKL
		<p>Connection Cable</p> <p>with open end, serves to connect the illuminated emergency stops to a voltage source. Length: approx. 30 cm, cross section 0.34 mm² (AWG22)</p>	VK_BKL034

About Us

Control Units

→ Actuators

Panel Mount Jacks

Bus Technology

Enclosures

Terminal Blocks

Pedal Switches

Limit Switches

Type Index

Emergency Stops Mushroom Heads

About Us

Control Units

Actuators

Panel Mount Jacks

Bus Technology

Enclosures

Terminal Blocks

Pedal Switches

Limit Switches

Type Index

Illustration

Dimensions

Description

Type

IP65



Emergency-stop Head

Series	QUARTEX-R
Panel cut-out	Ø 22.3 mm
foolproof	Yes
switching position indicator	Yes
anti-lock collar	Yes
release	twist right or left
Standard	EN 60947-5-1, EN 60947-5-5, EN ISO 13850



suitable contact blocks

ASI DS DT ET M

mushroom head	red
front bezel	yellow

QRBUV70

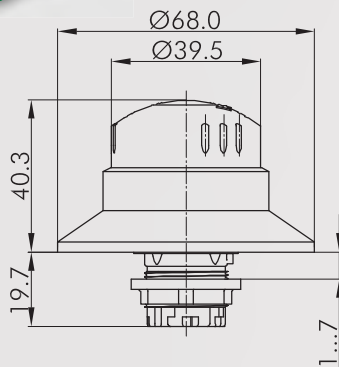

IP65



Mushroom Head, latch-type

other mushroom colours on request
must be mounted onto yellow background!

Series	QUARTEX-R
Panel cut-out	Ø 22.3 mm
foolproof	No
switching position indicator	No
anti-lock collar	No
release	twist
Standard	EN 60947-5-1, EN 60947-5-5, EN ISO 13850



suitable contact blocks

ASI DS DT ET M

mushroom head	red
front bezel	charcoal

QRV

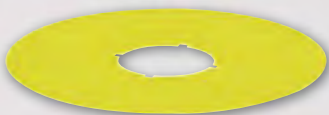
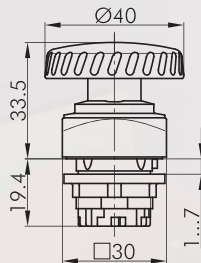

Yellow Nameplate

self-adhesive PVC foil	
printing on request	
outer dia. 75 mm	
for mounting dia. 22 mm	
Series	SHORTRON
Panel cut-out	Ø 22.3 mm
colour	yellow

NAS_22



Yellow Nameplate with quadrilingual imprint

self-adhesive PVC foil	
outer dia. 75 mm	
for mounting dia. 22 mm	
Series	SHORTRON
Panel cut-out	Ø 22.3 mm
colour	yellow

NAS_22_548

Mushroom Heads Emergency Stops

About Us

Control Units
→ Actuators

Panel Mount Jacks

Bus Technology



Enclosures

Terminal Blocks

Pedal Switches

Limit Switches

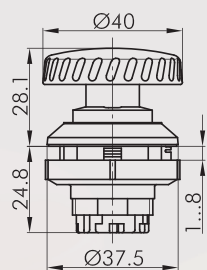
Type Index

Illustration	Dimensions	Description	Type
		<p>Mushroom Head, latch-type must be mounted onto yellow background!</p> <p>Series KOMBITAST-R Panel cut-out Ø 30.5 mm foolproof No switching position indicator No anti-lock collar No release twist Standard EN 60947-5-1, EN 60947-5-5, EN 60068, EN ISO 13850</p> <p> </p> <p>suitable contact blocks ASI DS DT ET M</p> <p>front bezel charcoal</p>	KRBV

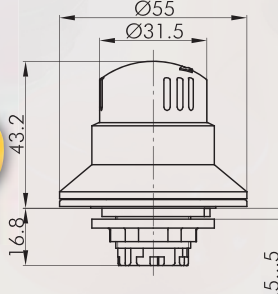
		<p>Emergency-stop Head consisting of QRBUV and adapter</p> <p>Series KOMBITAST-R-JUWEL Panel cut-out Ø 30.5 mm foolproof Yes switching position indicator Yes anti-lock collar Yes release twist right or left</p> <p>suitable contact blocks ASI DS DT ET M</p> <p>mushroom head red front bezel yellow</p>	KRBUV
--	--	---	--------------

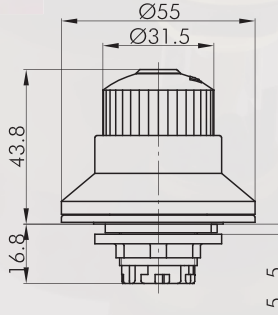
		<p>Emergency-stop Head consisting of QRBUVSE and adapter</p> <p>Series KOMBITAST-R-JUWEL Panel cut-out Ø 30.5 mm foolproof Yes switching position indicator Yes anti-lock collar Yes release key release</p> <p>suitable contact blocks ASI DS DT ET M</p> <p>mushroom head red front bezel yellow</p>	KRBUVSE
---	---	---	----------------

Emergency Stops

About Us

Control Units

Actuators

Panel Mount Jacks

Bus Technology

Enclosures

Terminal Blocks

Pedal Switches

Limit Switches

Type Index

Illustration

Dimensions

Description

Type

IP65



Emergency-stop Head

Series	KOMBITAST-RJUWEL
Panel cut-out	Ø 30.5 mm
foolproof	Yes
switching position indicator	Yes
anti-lock collar	Yes
release	twist right or left
Standard	EN 60947-5-1, EN 60947-5-5, EN ISO 13850



suitable contact blocks

ASI DS DT ET M

mushroom head	red
front bezel	yellow

KRBUV70

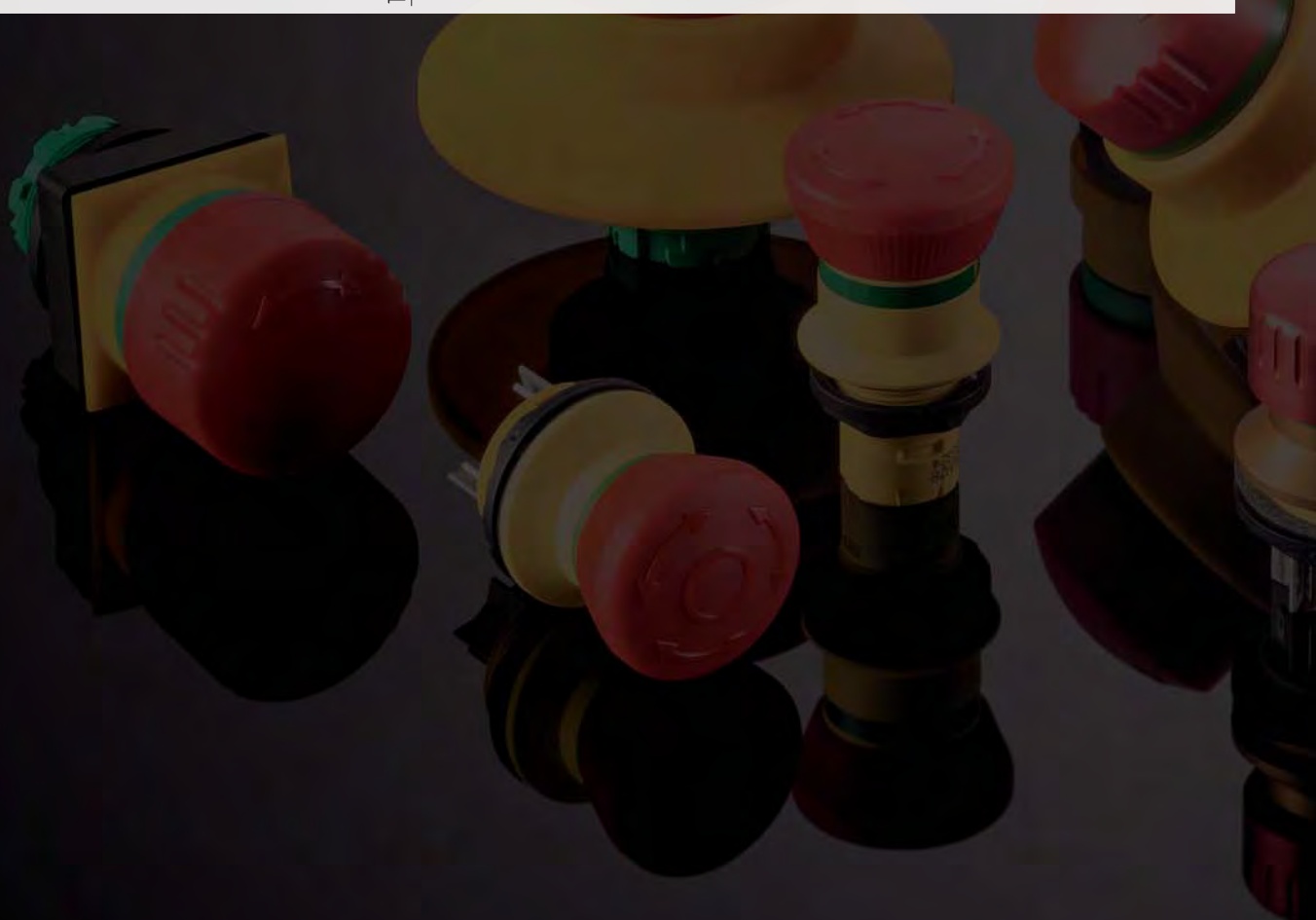
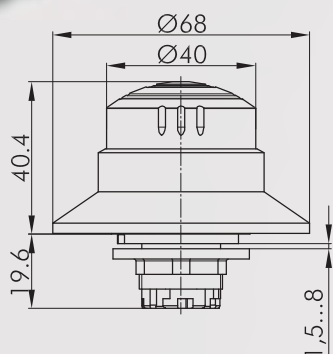

Emergency Stops

Illustration

Dimensions

Description

Type

IP65

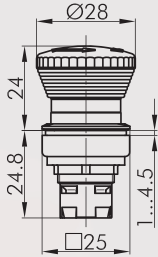

Emergency-stop Head

Series	OKTRON-JUWEL
Panel cut-out	23 x 23 mm
foolproof	Yes
switching position indicator	Yes
anti-lock collar	No
release	twist right or left
Standard	EN 60947-5-1, EN 60947-5-5, EN ISO 13850



suitable contact blocks

ASI AZ BZ BZ PTP PTF

mushroom head red
front bezel yellow

OKJUV

IP65

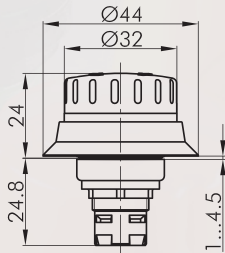

Emergency-stop Head

Series	OKTRON-JUWEL
Panel cut-out	23 x 23 mm
foolproof	Yes
switching position indicator	Yes
anti-lock collar	Yes
release	twist right or left
Standard	EN 60947-5-1, EN 60947-5-5, EN ISO 13850



suitable contact blocks

ASI AZ BZ BZ PTP PTF

knob colour red
front bezel yellow

OKJBUV



Yellow Nameplate

self-adhesive PVC foil	
printing on request	
outer dia. 60 mm	
for mounting aperture 23 x 23 mm	
Series	OKTRON-JUWEL
Panel cut-out	23 x 23 mm
colour	yellow

NAS_23



Yellow Nameplate with quadrilingual imprint

self-adhesive PVC foil	
outer dia. 60 mm	
for mounting aperture 23 x 23 mm	
Series	OKTRON-JUWEL
Panel cut-out	23 x 23 mm
colour	yellow

NAS_23_548

About Us

Control Units

→ Actuators

Panel Mount Jacks

Bus Technology

Enclosures

Terminal Blocks

Pedal Switches

Limit Switches

Type Index

Emergency Stops

About Us

Control Units

Panel Mount Jacks

Bus Technology

Enclosures

Terminal Blocks

Pedal Switches

Limit Switches

Type Index

Illustration

Dimensions

Description

Type

IP65

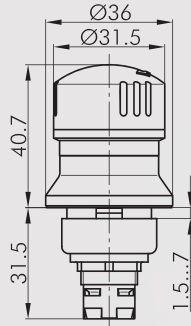

Emergency-stop Head

Series QUARTRON-JUWEL
 Panel cut-out 24 x 24 mm
 foolproof Yes
 switching position indicator Yes
 anti-lock collar No
 release twist right or left
 Standard EN 60947-5-1, EN 60947-5-5, EN ISO 13850



suitable contact blocks

ASI A AZ PTP PTF

mushroom head red
 front bezel yellow

QXJUV

IP65

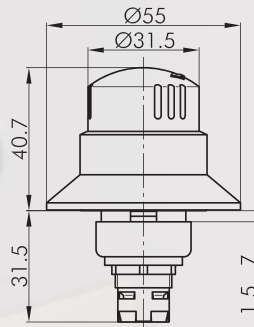

Emergency-stop Head

Series QUARTRON-JUWEL
 Panel cut-out 24 x 24 mm
 foolproof Yes
 switching position indicator Yes
 anti-lock collar Yes
 release twist right or left
 Standard EN 60947-5-1, EN 60947-5-5, EN ISO 13850



suitable contact blocks

ASI A AZ PTP PTF

mushroom head red
 front bezel yellow

QXJBV

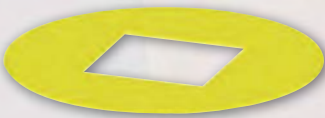

Yellow Nameplate

self-adhesive PVC foil
 printing on request
 outer dia. 60 mm
 for mounting aperture 24 x 24 mm
 Series QUARTRON-JUWEL
 Panel cut-out 24 x 24 mm
 colour yellow

NAS_24



Yellow Nameplate with quadrilingual imprint

self-adhesive PVC foil
 outer dia. 60 mm
 for mounting aperture 24 x 24 mm
 Series QUARTRON-JUWEL
 Panel cut-out 24 x 24 mm
 colour yellow

NAS_24_548

Emergency Stops

About Us

Control Units

→ Actuators

Panel Mount Jacks

Bus Technology

Enclosures

Terminal Blocks

Pedal Switches

Limit Switches

Type Index

Illustration

Dimensions

Description

Type

IP65

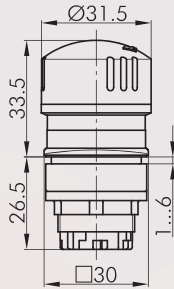

Emergency-stop Head

Series	QUARTEX-R-JUWEL
Panel cut-out	26 x 26 mm
foolproof	Yes
switching position indicator	Yes
anti-lock collar	No
release	twist right or left
Standard	EN 60947-5-1, EN 60947-5-5, EN ISO 13850



suitable contact blocks



mushroom head red
front bezel yellow

QRJUV